

**PENNSYLVANIA HISTORIC RESOURCE SURVEY FORM**  
 Bureau for Historic Preservation  
 PA Historical & Museum Commission

Box 1026  
 Harrisburg, PA 17120

9. HISTORICAL DATA

8. USGS QUAD.

UTM's: Zone Dawson

E	6	0	8	2	4	0	
N	4	4	3	8	2	3	0
E							
N							

Designer/Engineer:

Taylor & Romine

Builder/Contractor:

A & P Roberts Co., Pencoyd Iron Works

Bridge Company:

Unknown

Date(s): 1899; basis "plaque" built

1974; basis repaired deck

\_\_\_\_\_ ; basis \_\_\_\_\_

\_\_\_\_\_ ; basis \_\_\_\_\_

Use: vehicular present; vehicular original.

10. SITE PLAN

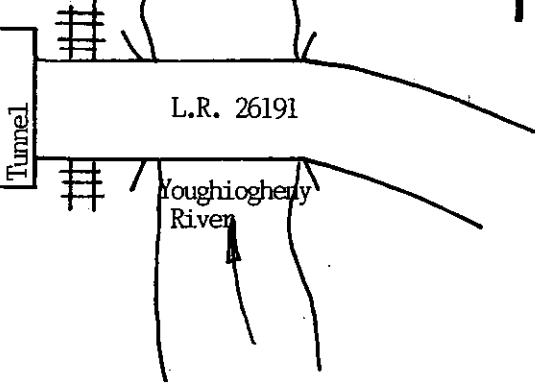

11. INTEGRITY

- \_\_\_\_\_ altered; \_\_\_\_\_
- X unaltered; \_\_\_\_\_
- \_\_\_\_\_ moved; \_\_\_\_\_

Explain:

12. VIEW

no.

PHOTO

13. COMMENTS

Unusual features:

Tunnels before bridge; one way lane, sidewalk made of wood

Locale/environment:

Wooded undeveloped area.

Machinery (describe/identify type/equipment):

N/A

14. DIMENSIONS

spans: 18 no., 811 ft. 0/A  
 main: 2 no., 181 ft.  
 secondary: 15 no., 32 ft.  
 approach: 2 no., 16 ft.  
 piers: \_\_\_\_\_ no.  
 towers: \_\_\_\_\_ no., \_\_\_\_\_ ft.

1. County  
 Fayette

2. Municipality  
 Perry

3. Structure No.  
 26191

4. Survey Code  
 12-310 T-22

5. Present Name  
 Layton Bridge

6. Other name (historic name if any)  
 N/A

7. Crossing  
 I.R. 26191 over Youghiogheny River

15. TYPE

CHARACTERISTICS

Truss: continuous/cantilever:

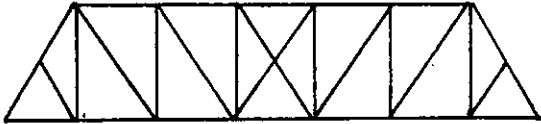

- webbing: lattice, 2 spans, 7 panels each
- anchor span: \_\_\_\_\_
- cantilever span: \_\_\_\_\_
- suspended span: \_\_\_\_\_
- thru/deck/low (pony): full-slope/half-hip.
- connections: pin/riveted.
- eyebars: loop welded/die forged.
- railing: channels
- columns: lattice & angle

Arch: masonry/metal: Built 1899 by  
 A & P Roberts Co., Pencoyd Iron Works,  
 Pencoyd, PA - President - W.H. Brown,  
 Directors - P.G. Cochran, J.R. Laughrey,  
 I.S. Newmyer, J.C. Core, A.C. Sherrard,  
 E.I. Taylor, W.I. Sherrard, M.M.  
 Cochran, I.H. Wortz. Engineers -

- thru/deck/1/2-thru.
- fixed (hingeless) /1/2/3-hinged.
- ribs: solid/braced; crescent/parallel.
- spandrels: open/solid/braced.
- intrados/vault; ribbed/solid.
- shape: semi-circular/elliptical/segmental; stilted.
- skew

Suspension: Taylor & Romine

- stiffening: braced-chain (1/2/3-hinged) /suspended truss.
- wire cable: twisted/parallel.
- eyebar chain.
- back-stay: straight/curved.

Bascule:

- single/double leaf.
- rolling lift: Schertzer.
- trunnion: simple (Chicago) /multiple (Strauss).
- counterweights: heel/overhead.
- Page/Rail.
- semi-lift/direct lift.

Swing:

- bearing: center/rim/combination.
- (see Truss above).

Vertical Lift:

- (see Truss above).

Other:

- other: \_\_\_\_\_

16. MATERIALS (primary)

Superstructure	type	treatment/finish	source
main span:	<u>steel</u>	_____	<u>Carnegie</u>
towers:	_____	_____	_____
railings:	_____	_____	_____
Substructure			
piers:	<u>stone</u>	<u>coursed broken</u>	_____
abutments:	<u>stone</u>	<u>face</u>	_____
wings:	_____	_____	_____
intrados/ribs:	_____	_____	_____
voussoirs:	_____	_____	_____

17. PHOTO NO's.

Proof Sheets  
 12-3(27-38) FAY - 2  
 12-4(1) FAY - 3

18. PREPARED BY: D. Piccolomini & M. Francis

AGENCY/ORGANIZATION: PA DOT  
 ; DATE:

7/82

Survey Number: T-22

Bridge Name and Address: Layton Bridge  
L.R. 26191 over Youghiogheny River  
Fayette County

Owner: Commonwealth of Pennsylvania  
Department of Transportation  
Transportation & Safety Building  
Harrisburg, Pennsylvania 17120

Statement of Significance: The Layton Bridge is an unusually configured example of a Pratt truss bridge. The pin-connected truss is a through truss in which the road deck passes midway through the truss. The standard configuration for a through truss situates the road deck just above the bottom chord. On the Layton Bridge the floorbeams frame into the verticals high above the bottom chord. This unusual configuration is discernible only when the bridge is viewed in elevation. The Layton Bridge is the only example of this type among the fourteen Pratt through trusses included in the nomination. It was built in 1899 by Pencoyd Iron Works, which was operated by the A. and P. Roberts Company of Philadelphia.

Area of Significance: Engineering.

Boundary Description: The nominated property consists of a 811 feet long by 25 feet wide rectangle whose vertices coincide with the outside corners of the bridge's abutments, and includes only bridge superstructure and substructure.

Acreage of Nominated Property: Less than one acre.

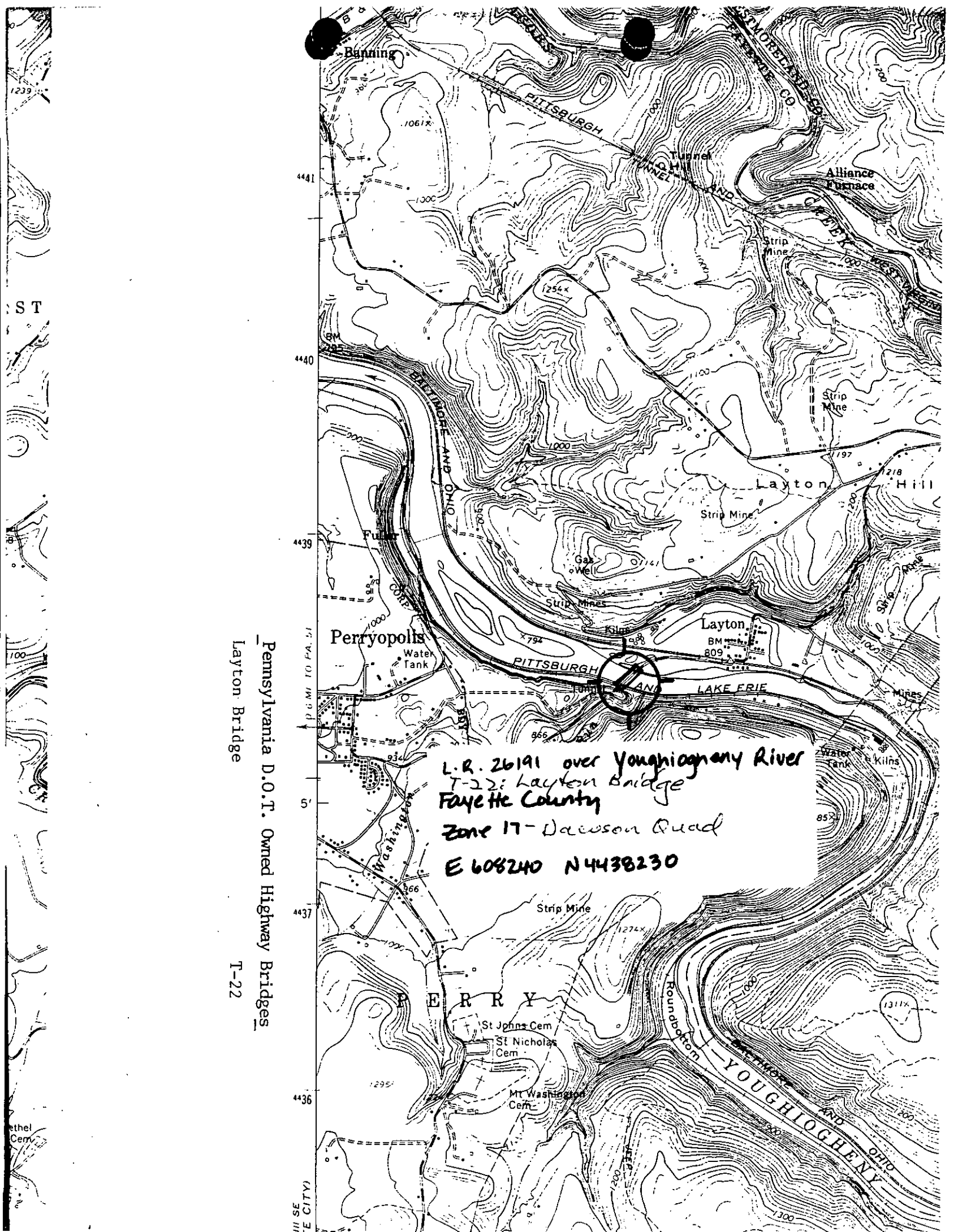

L.R. 26191 over Youghiogheny River  
T-22: Layton Bridge  
Fayette County  
Zone 17 - Dawson Quad  
E 608240 N 4438230

Pennsylvania D.O.T. Owned Highway Bridges  
Layton Bridge  
T-22

ST

Ethel Cem