

298

United States Department of the Interior  
National Park Service

National Register of Historic Places  
Registration Form

JAN 23 1990

This form is for use in nominating or requesting determinations of eligibility for individual properties or districts. See instructions in *Guidelines for Completing National Register Forms* (National Register Bulletin 16). Complete each item by marking "x" in the appropriate box or by entering the requested information. If an item does not apply to the property being documented, enter "N/A" for "not applicable." For functions, styles, materials, and areas of significance, enter only the categories and subcategories listed in the instructions. For additional space use continuation sheets (Form 10-900a). Type all entries.

1. Name of Property

historic name Chicken Creek Bridge  
other names/site number Same

2. Location

street & number SE 1/4, SE 1/4, NW 1/4, NE 1/4, S7, T14S, R19E  not for publication  
city, town Lone Star  vicinity  
state Kansas code KS county Douglas code 045 zip code 66006

3. Classification

Ownership of Property	Category of Property	Number of Resources within Property	
<input type="checkbox"/> private	<input type="checkbox"/> building(s)	Contributing	Noncontributing
<input checked="" type="checkbox"/> public-local	<input type="checkbox"/> district	_____	_____ buildings
<input type="checkbox"/> public-State	<input type="checkbox"/> site	_____	_____ sites
<input type="checkbox"/> public-Federal	<input checked="" type="checkbox"/> structure	<u>1</u>	_____ structures
	<input type="checkbox"/> object	_____	_____ objects
		<u>1</u>	_____ Total

Name of related multiple property listing:  
Masonry Arch Bridges of Kansas

Number of contributing resources previously listed in the National Register 0

4. State/Federal Agency Certification

As the designated authority under the National Historic Preservation Act of 1966, as amended, I hereby certify that this  nomination  request for determination of eligibility meets the documentation standards for registering properties in the National Register of Historic Places and meets the procedural and professional requirements set forth in 36 CFR Part 60. In my opinion, the property  meets  does not meet the National Register criteria.  See continuation sheet.

Ramon Rowley State Historic Preservation Officer January 8, 1990  
Signature of certifying official Date  
Kansas State Historical Society  
State or Federal agency and bureau

In my opinion, the property  meets  does not meet the National Register criteria.  See continuation sheet.

\_\_\_\_\_  
Signature of commenting or other official Date  
\_\_\_\_\_  
State or Federal agency and bureau

5. National Park Service Certification

I, hereby, certify that this property is:

- entered in the National Register.  
 See continuation sheet.
- determined eligible for the National Register.  See continuation sheet.
- determined not eligible for the National Register.
- removed from the National Register.
- other, (explain:)

Beth Boland 9/5/90  
\_\_\_\_\_  
\_\_\_\_\_  
\_\_\_\_\_  
\_\_\_\_\_  
\_\_\_\_\_  
Signature of the Keeper Date of Action

---

**6. Function or Use**

---

Historic Functions (enter categories from instructions)

Transportation: Road related  
(Vehicular): Bridge  

---

---

Current Functions (enter categories from instructions)

Transportation: Road related  
(Vehicular): Bridge  

---

---

---

**7. Description**

---

Architectural Classification

(enter categories from instructions)

Other: Masonry Arch  

---

---

Materials (enter categories from instructions)

foundation \_\_\_\_\_

walls \_\_\_\_\_  
\_\_\_\_\_

roof \_\_\_\_\_

other Stone: limestone, concrete  

---

---

---

**Describe present and historic physical appearance.**

The Chicken Creek Bridge (c. 1913) spans the Chicken Creek and is located in Willow Springs Township in southwestern Douglas County (pop. 74,839) Kansas. The bridge is a filled spandrel, limestone veneer, single arch structure. The bridge stands in a rural location with a north to south orientation. Both the north and south gravel approaches curve gently, following the historic roadway pattern and also allowing a right angle approach to the waterway.

The bridge measures forty-two feet from out to out and fifteen feet, four inches from curb to curb. The semi-circular arch spans fourteen and a half feet at its widest point and measures eleven feet from its summit to the water, its barrel measures eighteen feet, four inches. The impost walls which support the arch measure three feet, three inches from the water and project two and a half inches into the arch on each side. The parapets are centered over the arch and measure nineteen feet long, three feet nine inches high and one foot, six inches wide. The parapets bow out approximately one foot from an overall base measurement of eighteen feet, four inches to an overall summit measurement of nineteen feet, four inches. The roadway drop-off is eleven feet at the north end of the bridge and seventeen feet at the south end of the bridge.

The spandrel walls are composed primarily of coursed ashlar limestone blocks with some semi-coursed limestone rubble along the southeastern spandrel and are held together with mortar. The spandrel walls flair away from the arches, creating a surface that is intentionally concave. The parapet is a continuation of the spandrel walls and is built upon the outermost edge of the roadway. The Chicken Creek Bridge gains its strength from the arch, relying on compression to keep the stones in place. The earth loading allows for the even distribution of live loads and helps to strengthen the arch.

The bridge retains a high degree of architectural integrity although it does require some maintenance. A deep crack that runs from behind the keystone of the western arch to behind the third voussoir on the southern side of the arch is a structural problem that needs to be addressed. The face of the stone below the third voussoir has been sheared from the pressure of the shifting arch. If this structural problem is not addressed the arch will eventually collapse. Fixing this problem will entail building a wooden frame support inside the arch, running tie rods through the affected voussoirs, replacing the damaged stones, and repointing the necessary areas. Regrading of the roadbed to allow for proper drainage, reshoring of the abutments, reconstruction of the southern spandrel walls, and the general repointing will all facilitate the preservation of the Chicken Creek Bridge.

 See continuation sheet

**8. Statement of Significance**

Certifying official has considered the significance of this property in relation to other properties:

nationally  statewide  locally

Applicable National Register Criteria  A  B  C  D

Criteria Considerations (Exceptions)  A  B  C  D  E  F  G

Areas of Significance (enter categories from instructions)

Period of Significance

Significant Dates

Engineering

c. 1913

c. 1913

Transportation

c. 1913

c. 1913

Cultural Affiliation

N/A

Significant Person

N/A

Architect/Builder

Metsker, Benjamin Franklin

Babb, Ike

State significance of property, and justify criteria, criteria considerations, and areas and periods of significance noted above.

The Chicken Creek Bridge (c. 1913) is being nominated to the National Register under criterion C for its architectural significance as a limestone, single arch bridge and is to be included in the "Masonry Arch Bridges of Kansas" thematic resources nomination. The bridge's native limestone veneer, earth loaded construction, and arched form is typical of masonry arch bridge construction in Kansas.

The Chicken Creek Bridge is one of two masonry arch bridges of its size that remain in Douglas County, several more small stone bridges also remain extant. Until steel trusses were introduced in rural Douglas County during the early 20th century tributaries were bridged either in wood or stone. Most of the masonry arch and steel truss bridges were destroyed in the 1970s during an aggressive replacement campaign on the part of the county.

When the stone arch at Chicken Creek was constructed in 1913 it was considered a bridge. Today its fourteen foot, five inch span classifies it as a culvert. Under current Kansas law bridges are defined as structures having a clear span of more than twenty feet and culverts are defined as any structure spanning less than twenty feet. For purposes of inclusion in the "Masonry Arch Bridges of Kansas" thematic resources nomination the Chicken Creek Bridge shall be considered a bridge.

Chicken Creek Bridge spans the Chicken Creek in Willow Springs Township in southwestern Douglas County. The Chicken Creek Bridge has been part of the Willow Springs cultural landscape for three generations. The north and south gravel approaches to the bridge curve gently, following the historic roadway pattern that existed before the stone arch at Chicken Creek was built. It marks the way along a road that has changed slowly over time and is by its very nature important to preserve.

The Chicken Creek Bridge was constructed by Benjamin Franklin Metsker (1856-1935) and Ike Babb ( -1913). Metsker and Babb were paid \$113.25 and \$57.00 respectively for their work, as indicated in a July 28, 1913 entry in the Willow Springs Township, Douglas County, Kansas "Treasurer's Record Book." The stone for the bridge was quarried and gathered locally.

See continuation sheet

**9. Major Bibliographical References**

- Daron, Gulah and Garman. Metsker: Cousins by the Dozens - Descendants of three Metsker Brothers, Pioneer Residents of Douglas County, Kansas. (Oklahoma City, OK: 1973).
- Domer, Dennis. "Chicken Creek Bridge." (National Register Nomination, 1989).
- Domer, Dennis. Personal interview with Betty Lou Metsker, July, 1989.
- Domer, Dennis. Personal interview with Victor Solberg, July, 1989.
- Domer, Dennis. Personal interview with Pearl Stoebener, July, 1989.
- Douglas County, Kansas Atlas; 1873, 1887, 1902, 1921.

See continuation sheet

Previous documentation on file (NPS):

- preliminary determination of individual listing (36 CFR 67) has been requested
- previously listed in the National Register
- previously determined eligible by the National Register
- designated a National Historic Landmark
- recorded by Historic American Buildings Survey # \_\_\_\_\_
- recorded by Historic American Engineering Record # \_\_\_\_\_

Primary location of additional data:

- State historic preservation office
- Other State agency
- Federal agency
- Local government
- University
- Other

Specify repository:

Kansas State Historical Society

**10. Geographical Data**

Acreage of property Less than 1 acre

UTM References

A 1 5 2 9 6 6 6 5 4 3 0 2 8 6 0  
 Zone Easting Northing

C \_\_\_\_\_

B \_\_\_\_\_  
 Zone Easting Northing

D \_\_\_\_\_

See continuation sheet

Verbal Boundary Description The nominated property is located on the SE $\frac{1}{4}$ , SE $\frac{1}{4}$ , NW $\frac{1}{4}$ , NE $\frac{1}{4}$ , S7, T14S, R19E, Willow Springs Township, Douglas County, Kansas on a tract measuring 42' x 18'4" whose northeast corner is represented by the northeast corner of the bridge. Beginning at the northeast corner, the boundary proceeds 42' south, 18'4" west, 42' north, and 18'4" east to the point of beginning.

See continuation sheet

Boundary Justification

The boundary includes only that area that is historically associated with the nominated property.

See continuation sheet

**11. Form Prepared By**

name/title Martha Hagedorn-Krass, Architectural Historian

organization Kansas State Historical Society date January 2, 1990

street & number 120 W. 10th telephone 913-296-5264

city or town Topeka state Kansas zip code 66612



**United States Department of the Interior  
National Park Service**

**National Register of Historic Places  
Continuation Sheet**

Section number 8 Page 1

---

Metsker was a local stone mason who owned a farm about a mile south of the bridge. He was responsible for a number of bridges and houses in Willow Springs and Marion Townships although few remain extant, his own house and the Chicken Creek Bridge being exceptions. Babb was a laborer who was killed on a bridge project just north of Chicken Creek not long after he finished work on the Chicken Creek Bridge.

Generally speaking, stone bridges were more expensive to construct than metal bridges. Walter Sharp, a major stone arch contractor active in Kansas in the early twentieth century, estimated the cost differential at ten percent in 1904, although this too was somewhat misleading. Those contractors proposing steel bridges would often lower their bids one hundred to five hundred dollars when they found themselves as competitors to stone contractors. An additional selling point for stone bridges was their strength. There was ample evidence that stone bridges were far better able to withstand periodic floods than were their metal counterparts.

Sharp wrote in 1906 that "the rubble stone bridge looks solid, substantial and rustic; more like the handiwork of nature than of man. A rubble stone bridge can be built at a cost of a good steel bridge and it will stand the ravages of time without expense of repairing....The item of repairing and renewing floors of steel and wooden bridges is constantly increasing with each succeeding year, a fruitful source of annoyance and expense to the people. The money thus expended amounts in many instances to enough to build several good arch bridges in each county each season....Moreover, they are built by local labor out of native material, which is no small item to the taxpayer who foots the bills."

In Spring, 1989 Douglas County initiated plans to demolish the bridge, however the public outcry and National Register nomination that resulted from this news may have stayed these plans. The the Douglas County Public Works Department and the Douglas County Commission are reviewing a variety of alternatives, including the bridge's preservation and continued service. The bridge retains a high degree of architectural integrity although it does require some maintenance. Regrading of the roadbed to allow for proper drainage, reshoring of the abutments, reconstruction of the southern spandrel walls, repair of the structural crack in the western arch, and general repointing will all facilitate the preservation of the Chicken Creek Bridge.

In Kansas culverts that span off-system county roads do not need to meet the American Association of State and Highway Transportation Officials Standards (AASHTO) and they are not inventoried by the Kansas Department of Transportation for load bearing capacity. However, AASHTO standards are used for the construction of new culverts and these standards are often used as a way to measure the structural and functional capacity of older culverts. In the case of the Chicken Creek Bridge, its reclassification from a bridge to a culvert has resulted in neglected maintenance on it and an assumption that it would be replaced. Regular inspection and continued maintenace on these off-system structures would address the liability concerns that some county engineers harbour about continued use of older bridges and culverts.

United States Department of the Interior  
National Park Service

National Register of Historic Places  
Continuation Sheet

Section number   9   Page   1  

---

Douglas County, Kansas. Willow Springs Township. Statistical Rolls,  
1926-1935.

Douglas County, Kansas. Willow Springs Township. Treasurer's Record Book.  
28 July 1913.

Jochims, Larry. "Masonry Arch Bridges of Kansas." (Thematic resources  
nomination). Kansas State Historical Society. April, 1985.

Kansas City Star, 25 March 1906.

Middlemas, Keith. Letter to Martha Hagedorn-Krass, 24 July 1989.

U.S. Census. Kansas. Douglas County. Willow Springs Township. 1875, 1900,  
1905, 1910, 1915, 1925.

United States Department of the Interior  
National Park Service

National Register of Historic Places  
Inventory—Nomination Form

For NPS use only  
received 5/20/85  
date entered

Continuation sheet

Item number

Page 4 of 4

Multiple Resource Area  
Thematic Group

Name Masonry Arch Bridges of Kansas Thematic Resources  
State KANSAS Butler Co & others

Nomination/Type of Review

Date/Signature

31. Walnut Creek Bridge

Entered in the  
National Register

Keeper

Delores Byers 7/2/85

Attest

32. Pawnee River Tributary  
Bridge

Substantive Review

Keeper

Beth Grovener 7/2/85

Attest

33. Silver Creek Bridge

Substantive Review

Keeper

Beth Grovener 1/30/87

Attest

34. Chicken Creek Bridge

Substantive Review

Keeper

Beth Boland 3/5/90

Attest

35. Thomas Arch Bridge

Entered in the  
National Register

Keeper

5/16/80

Attest

36.

Keeper

Attest

37.

Keeper

Attest

38.

Keeper

Attest

39.

Keeper

Attest

40.

Keeper

Attest

United States Department of the Interior  
National Park Service

National Register of Historic Places  
Continuation Sheet

Section number \_\_\_\_\_ Page \_\_\_\_\_

SUPPLEMENTARY LISTING RECORD

NRIS Reference Number: 90000298

Date Listed: 3/5/90

Chicken Creek Bridge  
Property Name

Douglas  
County

KS  
State

Multiple Name

-----  
This property is listed in the National Register of Historic Places in accordance with the attached nomination documentation subject to the following exceptions, exclusions, or amendments, notwithstanding the National Park Service certification included in the nomination documentation.

Beth Boland  
Signature of the Keeper

3/5/90  
Date of Action

=====

Amended Items in Nomination:

Item #2: Location: The correct locational description is SW 1/4, SW 1/4, NW 1/4, NE 1/4, S7, T14S, R19E.

Item #8: Significance:

Chicken Creek Bridge is significant under criterion C only, in the area of architecture. Transportation is not an applicable area of significance.

Item #10: Verbal Boundary Description:

The first two Section references are SW 1/4, SW 1/4 (see locational information, above).

DISTRIBUTION:

- National Register property file
- Nominating Authority (without nomination attachment)

UNITED STATES DEPARTMENT OF THE INTERIOR  
NATIONAL PARK SERVICE

NATIONAL REGISTER OF HISTORIC PLACES  
EVALUATION/RETURN SHEET

REQUESTED ACTION: NOMINATION

PROPERTY NAME: Chicken Creek Bridge

MULTIPLE NAME: Masonry Arch Bridges of Kansas TR

STATE & COUNTY: KANSAS, Douglas

DATE RECEIVED: 1/23/90      DATE OF PENDING LIST: 2/07/90  
DATE OF 16TH DAY: 2/23/90      DATE OF 45TH DAY: 3/09/90  
DATE OF WEEKLY LIST:

REFERENCE NUMBER: 90000298

NOMINATOR: STATE

REASONS FOR REVIEW:

APPEAL: N    DATA PROBLEM: N    LANDSCAPE: N    LESS THAN 50 YEARS: N  
OTHER: N    PDIL: N    PERIOD: N    PROGRAM UNAPPROVED: N  
REQUEST: N    SAMPLE: N    SLR DRAFT: Y    NATIONAL: N

COMMENT WAIVER: N

ACCEPT     RETURN     REJECT    3/5/90 DATE

ABSTRACT/SUMMARY COMMENTS:

RECOM./CRITERIA Accept - c  
REVIEWER Boland  
DISCIPLINE Historian  
DATE 3/5/90

DOCUMENTATION see attached comments Y/N see attached SLR Y/N

CLASSIFICATION

\_\_\_ count      \_\_\_ resource type

STATE/FEDERAL AGENCY CERTIFICATION

FUNCTION

\_\_\_ historic      \_\_\_ current

DESCRIPTION

\_\_\_ architectural classification  
\_\_\_ materials  
\_\_\_ descriptive text

SIGNIFICANCE

Period      Areas of Significance--Check and justify below

Specific dates      Builder/Architect  
Statement of Significance (in one paragraph)

- \_\_\_ summary paragraph
- \_\_\_ completeness
- \_\_\_ clarity
- \_\_\_ applicable criteria
- \_\_\_ justification of areas checked
- \_\_\_ relating significance to the resource context
- \_\_\_ relationship of integrity to significance
- \_\_\_ justification of exception
- \_\_\_ other

BIBLIOGRAPHY

GEOGRAPHICAL DATA

\_\_\_ acreage      \_\_\_ verbal boundary description  
\_\_\_ UTMs      \_\_\_ boundary justification

ACCOMPANYING DOCUMENTATION/PRESENTATION

\_\_\_ sketch maps      \_\_\_ USGS maps      \_\_\_ photographs      \_\_\_ presentation

OTHER COMMENTS

Questions concerning this nomination may be directed to

\_\_\_\_\_ Phone \_\_\_\_\_

Signed \_\_\_\_\_ Date \_\_\_\_\_











































CHICKEN CREEK  
BRIDGE  
WILLOW SPRINGS  
TWP., KS.  
LONE STAR QUAD  
UTM Coordinates  
15 296665  
4302860

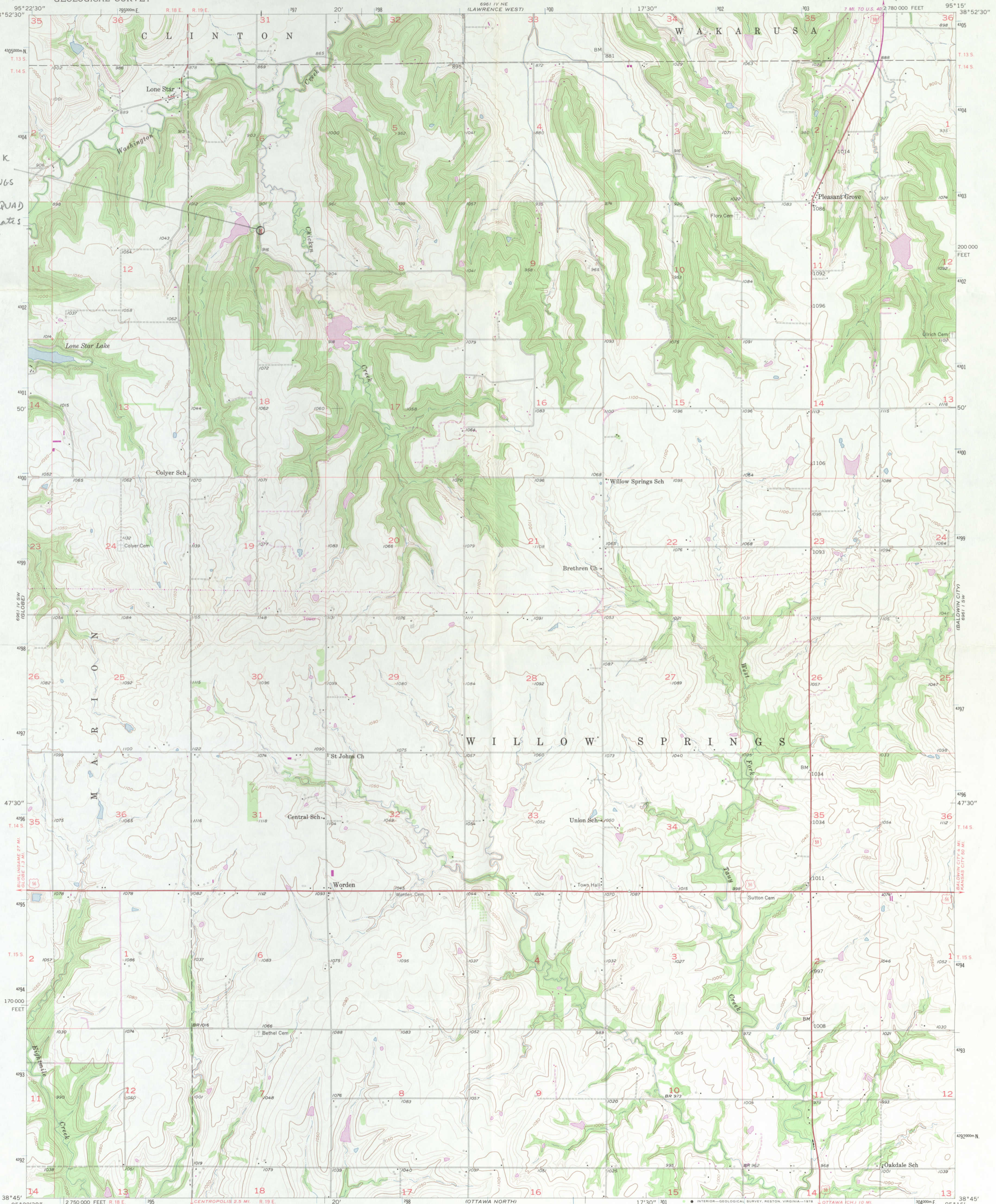

Mapped, edited, and published by the Geological Survey  
in cooperation with State of Kansas agencies  
Control by USGS and USC&GS  
Topography from aerial photographs by multiplex methods  
Aerial photographs taken 1947-1948. Field check 1957  
Polyconic projection. 1927 North American datum  
10,000-foot grid based on Kansas coordinate system, north zone  
1000-meter Universal Transverse Mercator grid ticks,  
zone 15, shown in blue  
Revisions shown in purple compiled in cooperation with  
State of Kansas agencies from aerial photographs taken  
1977. Map edited 1978. This information not field checked

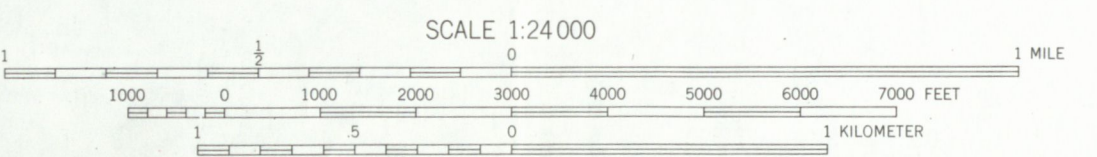
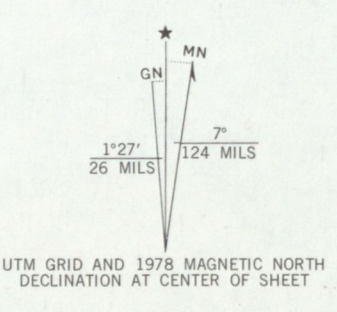

CONTOUR INTERVAL 10 FEET  
NATIONAL GEODETIC VERTICAL DATUM OF 1929

THIS MAP COMPLIES WITH NATIONAL MAP ACCURACY STANDARDS  
FOR SALE BY U. S. GEOLOGICAL SURVEY, DENVER, COLORADO 80225, OR RESTON, VIRGINIA 22092  
AND STATE GEOLOGICAL SURVEY, LAWRENCE, KANSAS 66044  
A FOLDER DESCRIBING TOPOGRAPHIC MAPS AND SYMBOLS IS AVAILABLE ON REQUEST

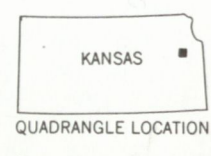

LONE STAR, KANSAS.  
N3845—W9515/7.5

1957  
PHOTOREVISED 1978  
AMS 6961 IV SE—SERIES V878





# KANSAS STATE HISTORICAL SOCIETY

CENTER FOR HISTORICAL RESEARCH

120 West Tenth ▪ Topeka, Kansas 66612-1291 ▪ 913/296-3251

KANSAS MUSEUM OF HISTORY

6425 South West Sixth ▪ Topeka, Kansas 66615-1099 ▪ 913/272-8681

January 11, 1990

JAN 23 1990

Ms. Carol Shull  
Interagency Resources Division  
National Park Service  
National Register Branch  
1100 L St., NW  
Room 6111 (Code 413)  
Washington, DC 20240

Dear Ms. Shull:

We are pleased to submit the following property for listing on the National Register.

Chicken Creek Bridge - Douglas County, Kansas

Sincerely yours,

Ramon Powers  
State Historic Preservation Officer

MHK/djw

Enc.

DATE 2-1-90  
TIME OF CALL \_\_\_\_\_ AM  
PM

TELEPHONE REPORT

1. CALL  TO:  FROM (Name)

Martha Hegedorn

2. ADDRESS (Tel. No. if needed)

KS JHPO

3. SUBJECT, PROJECT NO., ETC.

Chicken Creek Bridge

4. DETAILS OF DISCUSSION

Douglas Cty, KS  
There is a clerical error in  
Legal description of this  
homination, which was submitted to NR  
in the last month  
SW quarter / SW quarter  
shoud start legal  
description w/ SE, SE.

This error shows up in #2  
on the form.

T told her we'd do an  
SLR to correct and that Beth  
would call her so that language  
could be agreed upon in SLR

NAME OF PERSON PLACING/RECEIVING CALL

C. Hull

TITLE

OFFICE