

United States Department of the Interior
National Park Service

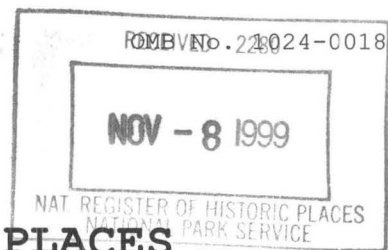

NATIONAL REGISTER OF HISTORIC PLACES REGISTRATION FORM

This form is for use in nominating or requesting determinations for individual properties and districts. See instructions in *How to Complete the National Register of Historic Places Registration Form* (National Register Bulletin 16A). Complete each item by marking "x" in the appropriate box or by entering the information requested. If any item does not apply to the property being documented, enter "N/A" for "not applicable." For functions, architectural classification, materials, and areas of significance, enter only categories and subcategories from the instructions. Place additional entries and narrative items on continuation sheets (NPS Form 10-90Ca). Use a typewriter, word processor, or computer, to complete all items.

1. Name of Property

historic name M-26/Silver River Culvert
other names/site number _____

2. Location

street & number Highway M-26 over Silver River
not for publication N/A
city or town Eagle Harbor Township vicinity N/A
state Michigan code MI county Keweenaw code 083
zip code 49951

3. State/Federal Agency Certification

As the designated authority under the National Historic Preservation Act of 1986, as amended, I hereby certify that this x nomination _____ request for determination of eligibility meets the documentation standards for registering properties in the National Register of Historic Places and meets the procedural and professional requirements set forth in 36 CFR Part 60. In my opinion, the property x meets _____ does not meet the National Register Criteria. I recommend that this property be considered significant _____ nationally _____ statewide x locally. (____ See continuation sheet for additional comments.)

[Signature]
Signature of certifying official
Michigan State Historic Preservation Office
State or Federal agency and bureau

9.29.99
Date

In my opinion, the property _____ meets _____ does not meet the National Register criteria. (____ See continuation sheet for additional comments.)

Signature of commenting or other official Date

State or Federal agency and bureau

4. National Park Service Certification

I, hereby certify that this property is:

☒ entered in the National Register

See continuation sheet.

☐ determined eligible for the

National Register

See continuation sheet.

☐ determined not eligible for the

National Register

☐ removed from the National Register

☐ other (explain):

Signature of Keeper Date
of Action

5. Classification

Ownership of Property (Check as many boxes as apply)

☐ private
☐ public-local
☒ public-State
☐ public-Federal

Category of Property (Check only one box)

☐ building(s)
☐ district
☐ site
☒ structure
☐ object

Number of Resources within Property

Contributing	Noncontributing
<u>0</u>	<u>0</u> buildings
<u>0</u>	<u>0</u> sites
<u>1</u>	<u>0</u> structures
<u>0</u>	<u>0</u> objects
<u>1</u>	<u>0</u> Total

Number of contributing resources previously listed in the National Register N/A

Name of related multiple property listing (Enter "N/A" if property is not part of a multiple property listing.)

Historic Highway Bridges of Michigan, 1875-1948

6. Function or Use

Historic Functions (Enter categories from instructions)

Cat: TRANSPORTATION Sub: road-related (vehicular)

_____	_____
_____	_____
_____	_____
_____	_____
_____	_____
_____	_____

Current Functions (Enter categories from instructions)

Cat: TRANSPORTATION Sub: road-related (vehicular)

_____	_____
_____	_____
_____	_____
_____	_____
_____	_____
_____	_____

7. Description

Architectural Classification (Enter categories from instructions)

OTHER: multiplate steel culvert

Materials (Enter categories from instructions)

foundation (Substructure) CONCRETE

roof _____

walls _____

other (Superstructure) STEEL

Narrative Description (Describe the historic and current condition of the property on one or more continuation sheets.)

United States Department of the Interior
National Park Service

**NATIONAL REGISTER OF HISTORIC PLACES
CONTINUATION SHEET**

Section 7 Page 1 Silver River Culvert
name of property
Keweenaw County, Michigan
county and state

Description

The Silver River Culvert is situated almost four miles east of Eagle Harbor, in Eagle Harbor Township. The culvert carries Highway M-26 near the mouth of the Silver River, about a half mile from Lake Superior. It is configured as a single-barrel, multiplate steel culvert. The arches' portals are ringed with irregular stone voussoir veneers. The bridge's endwalls feature decorative decoratively placed fieldstones, laid with grapevine mortar joints. Similar stonework is used for the parapet walls that flank the asphalt roadway. A series of heavy stone bulkheads (eight on the south side, four on the north) with pyramidal concrete caps are built into each parapet; these extend below the roadway level to form pilasters along the sidewalls. Built around 1930, the Silver River Culvert is unaltered and in excellent condition.

8. Statement of Significance

Applicable National Register Criteria (Mark "x" in one or more boxes for the criteria qualifying the property for National Register listing)

- ☐ A Property is associated with events that have made a significant contribution to the broad patterns of our history.
- ☐ B Property is associated with the lives of persons significant in our past.
- ☒ C Property embodies the distinctive characteristics of a type, period, or method of construction or represents the work of a master, or possesses high artistic values, or represents a significant and distinguishable entity whose components lack individual distinction.
- ☐ D Property has yielded, or is likely to yield information important in prehistory or history.

Criteria Considerations (Mark "X" in all the boxes that apply.)

- ☐ A owned by a religious institution or used for religious purposes.
- ☐ B removed from its original location.
- ☐ C a birthplace or a grave.
- ☐ D a cemetery.
- ☐ E a reconstructed building, object, or structure.
- ☐ F a commemorative property.
- ☐ G less than 50 years of age or achieved significance within the past 50 years.

Areas of Significance (Enter categories from instructions)

ENGINEERING

Period of Significance circa 1930

Significant Dates circa 1930

Significant Person (Complete if Criterion B is marked above)
N/A

Cultural Affiliation N/A

Architect/Builder Keweenaw County Road Commission

Narrative Statement of Significance (Explain the significance of the property on one or more continuation sheets.)

9. Major Bibliographical References

(Cite the books, articles, and other sources used in preparing this form on one or more continuation sheets.)

Previous documentation on file (NPS)

- ☐ preliminary determination of individual listing (36 CFR 67) has been requested.
☐ previously listed in the National Register
☐ previously determined eligible by the National Register
☐ designated a National Historic Landmark
☐ recorded by Historic American Buildings Survey #
☐ recorded by Historic American Engineering Record #

Primary Location of Additional Data

- ☐ State Historic Preservation Office
☒ Other State agency
☐ Federal agency
☐ Local government
☐ University
☐ Other

Name of repository: Michigan Department of Transportation

10. Geographical Data

Acreage of Property less than one acre

UTM References (Place additional UTM references on a continuation sheet)

	Zone	Easting	Northing	Zone	Easting	Northing
1	<u>16</u>	<u>419180</u>	<u>5256960</u>	3	<u> </u>	<u> </u>
2	<u> </u>	<u> </u>	<u> </u>	4	<u> </u>	<u> </u>
<u> </u> See continuation sheet.						

Verbal Boundary Description (Describe the boundaries of the property on a continuation sheet.)

Boundary Justification (Explain why the boundaries were selected on a continuation sheet.)

United States Department of the Interior
National Park Service

**NATIONAL REGISTER OF HISTORIC PLACES
CONTINUATION SHEET**

Section 8 Page 1 Silver River Culvert
name of property
Keweenaw County, Michigan
county and state

Summary of Significance

In its scale and detailing, this structure closely resembles the Fanny Hooe Creek Bridge, built in 1927-28 by the Keweenaw County Road Commission for the Michigan State Highway Department. It is assumed that the Silver River Culvert was also constructed at about the same time by the county road commission, although M-26 was not designated as a state route until about 1935. One of many such small-scale structures that carry secondary roads over minor watercourses in the Upper Peninsula, this culvert is distinguished architecturally by its stone veneered sidewalls. It is thus eligible for listing in the National Register under Criterion C for its aesthetic treatment.

United States Department of the Interior
National Park Service

**NATIONAL REGISTER OF HISTORIC PLACES
CONTINUATION SHEET**

Section 9 Page 1 Silver River Culvert
name of property
Keweenaw County, Michigan
county and state

Bibliography

Archival Sources

Bridge Database. Michigan Department of Transportation, Lansing.

United States Department of the Interior
National Park Service

**NATIONAL REGISTER OF HISTORIC PLACES
CONTINUATION SHEET**

Section 10 Page 1 Silver River Culvert
name of property
Keweenaw County, Michigan
county and state

Verbal Boundary Description

The general area of the nominated property is a rectangle 40 feet wide, whose long center axis parallels the centerline of the bridge. The property is bounded at each end by the outer edges of the abutments.

Boundary Justification

Based on measurements provided by the Michigan Department of Transportation, the boundaries enclose the entire historic resource.

United States Department of the Interior
National Park Service

**NATIONAL REGISTER OF HISTORIC PLACES
CONTINUATION SHEET**

Section 10 Page 2 Silver River Culvert
name of property
Keweenaw County, Michigan
county and state

Index to Photographs

Photographer: Clayton Fraser, Fraserdesign
Date: 17 September 1995
Negatives: Michigan Department of Transportation, Lansing

- No. 1 East approach. View to west.
No. 2 South elevation. View to northeast.

11. Form Prepared By

name/title Clayton B. Fraser, Principal
organization Fraserdesign
street & number P.O. Box 6025
city or town Loveland state CO zip code 80537
telephone (970) 669-7969
date November 1998

Additional Documentation

Submit the following items with the completed form:

Continuation Sheets

Maps

A USGS map (7.5 or 15 minute series) indicating the property's location.

A sketch map for historic districts and properties having large acreage or numerous resources.

Photographs

Representative black and white photographs of the property.

Additional items (Check with the SHPO or FPO for any additional items)

Property Owner

(Complete this item at the request of the SHPO or FPO.)

name Michigan Department of Transportation
street & number 425 West Ottawa Street
telephone (517) 373-2114
city or town Lansing state MI zip code 48909

Paperwork Reduction Act Statement: This information is being collected for applications to the National Register of Historic Places to nominate properties for listing or determine eligibility for listing, to list properties, and to amend existing listings. Response to this request is required to obtain a benefit in accordance with the National Historic Preservation Act, as amended (16 U.S.C. 470 et seq.). Estimated Burden Statement: Public reporting burden for this form is estimated to average 18.1 hours per response including the time for reviewing instructions, gathering and maintaining data, and completing and reviewing the form. Direct comments regarding this burden estimate or any aspect of this form to the Chief, Administrative Services Division, National Park Service, P.O. Box 37127, Washington, DC 20013-7127; and the Office of Management and Budget, Paperwork Reductions Project (1024-0018), Washington, DC 20503.

UNITED STATES DEPARTMENT OF THE INTERIOR
NATIONAL PARK SERVICE

NATIONAL REGISTER OF HISTORIC PLACES
EVALUATION/RETURN SHEET

REQUESTED ACTION: NOMINATION

PROPERTY M26--Silver River Culvert
NAME:

MULTIPLE Highway Bridges of Michigan MPS
NAME:

STATE & COUNTY: MICHIGAN, Keweenaw

DATE RECEIVED: 11/08/99 DATE OF PENDING LIST: 11/23/99
DATE OF 16TH DAY: 12/09/99 DATE OF 45TH DAY: 12/23/99
DATE OF WEEKLY LIST:

REFERENCE NUMBER: 99001527

REASONS FOR REVIEW:

APPEAL: N DATA PROBLEM: N LANDSCAPE: N LESS THAN 50 YEARS: N
OTHER: N PDIL: N PERIOD: N PROGRAM UNAPPROVED: N
REQUEST: N SAMPLE: N SLR DRAFT: N NATIONAL: N

COMMENT WAIVER: N

☒ ACCEPT ☐ RETURN ☐ REJECT 12/17/99 DATE

ABSTRACT/SUMMARY COMMENTS:

Entered in the
National Register

RECOM./CRITERIA _____

REVIEWER _____ DISCIPLINE _____

TELEPHONE _____ DATE _____

DOCUMENTATION see attached comments Y/N see attached SLR Y/N

Highway Bridges of Michigan MPS

M26 -- Silver River Culvert

99001527



Silver River Culvert
Highway M-26 over Silver River
Keweenaw County, Michigan
Clayton Fraser

17 September 1995

MISHPO

South elevation, view to northeast

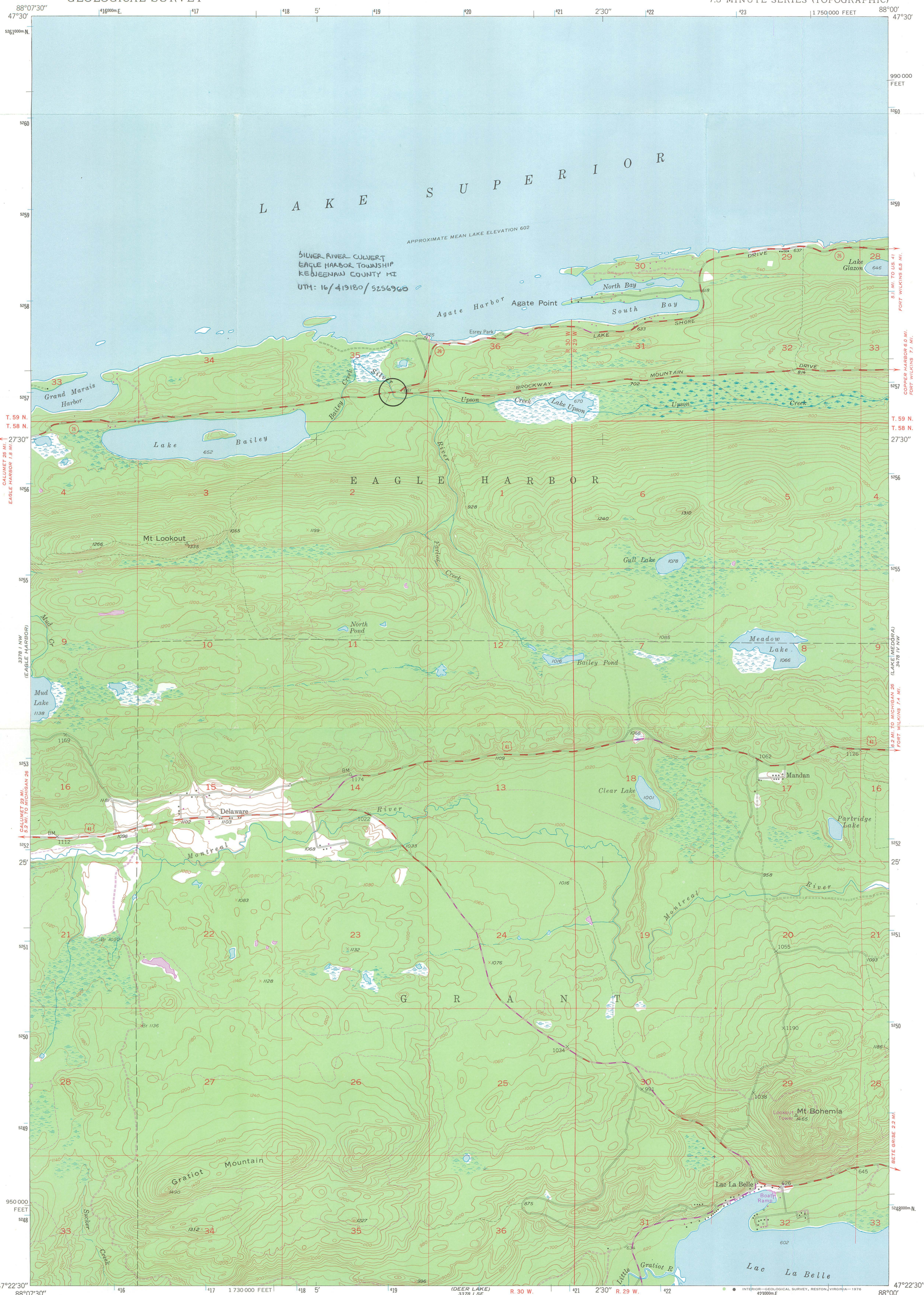

Mapped, edited, and published by the Geological Survey

Control by USGS and USC&GS

Topography from aerial photographs by multiplex methods

Aerial photographs taken 1943. Field checked 1948

Polyconic projection. 1927 North American datum

10,000-foot grid based on Michigan coordinate system,

north zone

1000-metre Universal Transverse Mercator grid ticks,

zone 16, shown in blue

Revisions shown in purple compiled from aerial photographs

taken 1975. This information not field checked

UTM GRID AND 1975 MAGNETIC NORTH
DECLINATION AT CENTER OF SHEET

THIS MAP IS AVAILABLE IN BOTH SHADED RELIEF AND CONTOUR EDITIONS

THIS MAP COMPLIES WITH NATIONAL MAP ACCURACY STANDARDS

FOR SALE BY U.S. GEOLOGICAL SURVEY, RESTON, VIRGINIA 22092

A FOLDER DESCRIBING TOPOGRAPHIC MAPS AND SYMBOLS IS AVAILABLE ON REQUEST

ROAD CLASSIFICATION

Medium-duty Light-duty

Unimproved dirt

U.S. Route State Route

DELAWARE, MICH.

N4722.5—W8800/7.5

1948

PHOTOREVISED 1975

AMS 3378 1 NE—SERIES V862