

Red Bridge

CHRI11

GENERAL DATA

structure no.:	433000.4	city/town:	10.5 miles southeast of Ozark
county:	Christian	feature inters.:	Bull Creek
		cadastral grid:	S8, T25N, R20W
		highway route:	County Road H14
		highway distr.:	8
		current owner:	Christian County

STRUCTURAL DATA

superstructure: steel, 3-panel, pin-connected Pratt pony truss
substructure: concrete abutments, wingwalls and piers (with rock backfill at abutments)

span number:	3	condition:	good
span length:	86.0'	alterations:	none
total length:	255.0'	floor/decking :	timber deck (planks laid on end)
roadway width:	11.5'	other features:	upper chord and inclined end post: 2 channels with cover plates and lacing; lower chord: 2 looped rectangular eyebars; vertical: 4 angles with lacing; diagonal: 2 looped square eyebars with turnbuckles; floor beam: I-beam field bolted to vertical; guardrail: 2 angles

HISTORICAL DATA

erection date: 1915
erection cost: unknown
designer: Canton Bridge Company, Canton OH
fabricator : Canton Bridge Company, Canton OH;
Jones and Laughlin Steel Company, Pittsburgh PA
contractor: Canton Bridge Company, Canton OH
references: Missouri Highway and Transportation Department, Structure Inventory and Appraisal: Structure Number 433000.4; Christian County Court Record, Book 14: 22 December 1914, 3 November 1915, located at Christian County Courthouse, Ozark, Missouri; field inspection by Clayton Fraser, 26 January 1990.
sign. rating: 52
evaluation: NRHP possibly eligible (uncommon multiple-span example of common truss type)

inventoried by: Clayton B. Fraser 26 February 1992

HAER INVENTORY

Missouri Historic Bridge Inventory

NAME(S) OF STRUCTURE

Red Bridge
MHTD: 433000.4

CHR11

DATE(S) OF CONSTRUCTION

1915

LOCATION

County Road H14 over Bull Creek; S8, T25N, R20W
10.5 miles southeast of Ozark; Christian County, Missouri

USE (ORIGINAL / CURRENT)

roadway bridge / roadway bridge

RATING NRHP possibly eligible (score: 52)

CONDITION

good

OWNER

Christian County

span number: 3
span length: 86.0'
total length: 255.0'
roadway wdt.: 11.5'

superstructure: steel, 3-panel, pin-connected Pratt pony truss
substructure: concrete abutments, wingwalls and piers (with rock backfill at abutments)
floor/decking: timber deck (planks laid on end)
other features: upper chord and inclined end post: 2 channels with cover plates and lacing; lower chord: 2 looped rectangular eyebars; vertical: 4 angles with lacing; diagonal: 2 looped square eyebars with turnbuckles; floor beam: I-beam field bolted to vertical; guardrail: 2 angles

The Red Bridge carries county road H14 across Bull Creek approximately 10½ miles southeast of Ozark. It was built by the Canton Bridge Company with steel rolled by the Jones and Laughlin Steel Company of Pittsburgh. With an overall length of 255 feet, the structure is a three-span, pin-connected Pratt pony truss. Because the truss has not been substantially altered, it retains a high degree of physical integrity.

From the turn of the century until the late 1910s, the Canton Bridge Company designed, fabricated and erected virtually all of Christian County's truss bridges. The Red Bridge reflects Canton's proclivity for pin-connected Pratt trusses. It typifies medium-scale truss design and detailing for its period of construction - and is one of thousands of Pratt pony trusses built throughout the state in the early 20th century and one of hundreds identified by the historic bridge inventory. Although its detailing is typical, the structure is distinguished by its multiplicity of spans. Multiple-span pony trusses are a relative rarity in Missouri, and the Red Bridge is a relatively long-span, particularly well-preserved example.

NAME(S) OF STRUCTURE

Red Bridge

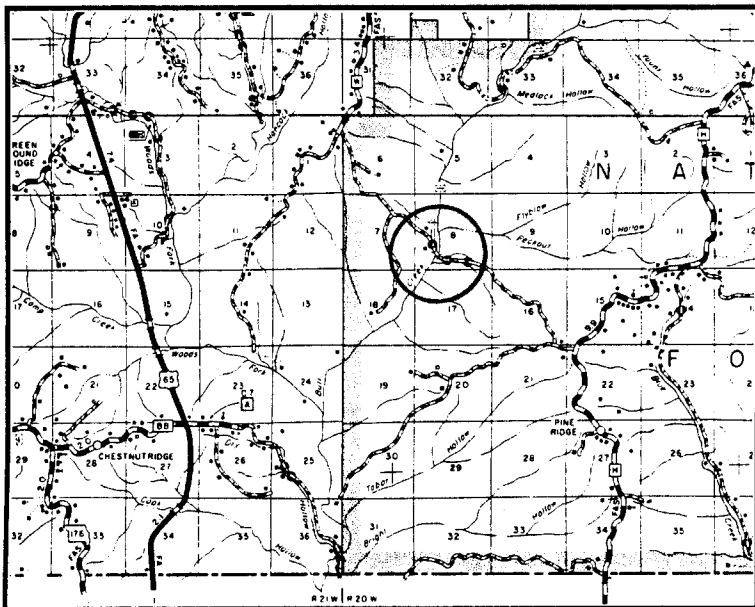
PHOTOS AND SKETCH MAP OF LOCATION**LOCATION MAP**

TAKEN FROM MISSOURI HIGHWAY AND TRANSPORTATION DEPARTMENT
GENERAL HIGHWAY MAP

SOURCES

Missouri Highway and Transportation Department, Structure Inventory and Appraisal: Structure Number 433000.4; Christian County Court Record, Book 14: 22 December 1914, 3 November 1915, located at Christian County Courthouse, Ozark, Missouri; field inspection by Clayton Fraser and Paula Sutton, 26 January 1990.

INVENTORIED BY

Clayton B. Fraser

AFFILIATION

Fraserdesign, Loveland CO

DATE

26 February 1990
