

BUILDING-STRUCTURE INVENTORY FORM

DIVISION FOR HISTORIC PRESERVATION  
NEW YORK STATE PARKS AND RECREATION  
ALBANY, NEW YORK (518) 474-0479

FOR OFFICE USE ONLY  
UNIQUE SITE NO. 121-05-0008  
QUAD \_\_\_\_\_  
SERIES \_\_\_\_\_  
NEG. NO. \_\_\_\_\_

YOUR NAME: John G. Wilson DATE: September 1978

YOUR ADDRESS: Wyoming, NY TELEPHONE: 495-6495

ORGANIZATION (if any): Arts Council for Wyoming County

NOV 06 1978

\*\*\*\*\*

IDENTIFICATION

- 1. BUILDING NAME(S): Crossman Bridge
- 2. COUNTY: Wyoming TOWN: Covington CITY: Covington VILLAGE: \_\_\_\_\_
- 3. STREET LOCATION: Crossman Rd; over Oatka Creek one mile north of Pearl Creek
- 4. OWNERSHIP: a. public  b. private
- 5. PRESENT OWNER: Wyoming County ADDRESS: Warsaw, NY
- 6. USE: Original: Vehicular bridge Present: Vehicular bridge
- 7. ACCESSIBILITY TO PUBLIC: Exterior visible from public road: Yes  No   
Interior accessible: Explain \_\_\_\_\_

12105.000008

DESCRIPTION

- 8. BUILDING MATERIAL: a. clapboard  b. stone  c. brick  d. board and batten   
e. cobblestone  f. shingles  g. stucco  other: \_\_\_\_\_
- 9. STRUCTURAL SYSTEM: a. wood frame with interlocking joints   
(if known) b. wood frame with light members   
c. masonry load bearing walls   
d. metal (explain) metal truss bridge  
e. other \_\_\_\_\_
- 10. CONDITION: a. excellent  b. good  c. fair  d. deteriorated
- 11. INTEGRITY: a. original site  b. moved  if so, when? \_\_\_\_\_  
c. list major alterations and dates (if known): \_\_\_\_\_

12. PHOTO:

13. MAP:



Crossman Bridge

Brewell Rd.

14. THREATS TO BUILDING: a. none known  b. zoning  c. roads   
 d. developers  e. deterioration   
 f. other: \_\_\_\_\_
15. RELATED OUTBUILDINGS AND PROPERTY:  
 a. barn  b. carriage house  c. garage   
 d. privy  e. shed  f. greenhouse   
 g. shop  h. gardens   
 i. landscape features: Spans Oatka Creek  
 j. other: \_\_\_\_\_
16. SURROUNDINGS OF THE BUILDING (check more than one if necessary):  
 a. open land  b. woodland   
 c. scattered buildings   
 d. densely built-up  e. commercial   
 f. industrial  g. residential   
 h. other: \_\_\_\_\_

17. INTERRELATIONSHIP OF BUILDING AND SURROUNDINGS:  
 (Indicate if building or structure is in an historic district)

Bridge crosses Oatka Creek 1 mile north of Pearl Creek at the site of one of the county's pioneer mill sites.

18. OTHER NOTABLE FEATURES OF BUILDING AND SITE (including interior features if known):  
 Over each end there are 2 plaques. One says, "Built by Groton Iron Bridge Co." and the other says, "H. C. Taylor, Commissioner."

SIGNIFICANCE

19. DATE OF INITIAL CONSTRUCTION: 1879

ARCHITECT: \_\_\_\_\_

BUILDER: Groton Iron Bridge Co.

20. HISTORICAL AND ARCHITECTURAL IMPORTANCE:

Few bridges remain from this period in Wyoming County. The bridge was built at a cost of \$1650.

21. SOURCES:

22. THEME: Transportation

Continuation Sheet: Bridge Inventory Form

Crossman Bridge

8. Substructure:

Material: Stone  
Piers: Stone masonry  
Abutments: mortared stone

9. Superstructure:

Material: Wrought iron  
Characteristics, details and members:  
Connections:  pin.  
 rigid.

Top Chords: Riveted channels with cap plates  
End Posts: Inclined channels with cap plates  
Bottom Chords: Rectilinear bars  
Posts: Two vertical channels with lattice bracing  
Diagonals: Double square bars with eyes  
Counters: Single round rods

18. a) Truss Configuration:

Main span type: Pratt Through/Pony/Deck

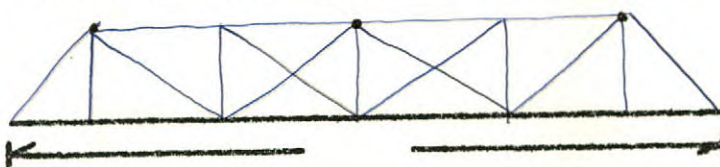

Secondary span type: \_\_\_\_\_ Through/Pony/Deck



b) No. of spans: 1 length overall: 124 feet

Span types:

- (1) truss (Pratt) length: 124 feet
- (2) \_\_\_\_\_ length: \_\_\_\_\_
- (3) \_\_\_\_\_ length: \_\_\_\_\_
- (4) \_\_\_\_\_ length: \_\_\_\_\_
- (5) \_\_\_\_\_ length: \_\_\_\_\_
- (6) \_\_\_\_\_ length: \_\_\_\_\_

No. of lanes: 1 width: 16' c to c.

20. Historical or Technological Significances:

- Unique/Unusual in its time: \_\_\_\_\_
- Rare survivor though of standard design: \_\_\_\_\_
- Typical example of its time and a common survivor: \_\_\_\_\_
- Other Remarks/Explanation: \_\_\_\_\_