

"THE BOOK OF CATALOGUES"

# "SWEET'S"

INDEXED CATALOGUE OF BUILDING CONSTRUCTION

FOR THE YEAR

1906

WITH AN INTRODUCTION BY  
THOMAS NOLAN, F.A.I.A.  
ASSISTANT PROFESSOR OF ARCHITECTURE  
UNIVERSITY OF PENNSYLVANIA

AND A RECOMMENDATION AS TO SCOPE, PURPOSE AND PLAN

FROM A NUMBER OF  
EMINENT ARCHITECTS

DEvised, COMPILED AND EDITED BY THE ARCHITECTURAL RECORD

THE ARCHITECTURAL RECORD CO.

14 and 16 Vesey St., New York City

∴  
1906

Monadnock Building, Chicago, Ill.

# CUMMINGS STRUCTURAL CONCRETE CO.

4 Smithfield Street  
PITTSBURG, Pa.

BELL TELEPHONE, 3189 COURT

ROBERT A. CUMMINGS, M. Am. Soc. C. E.  
Consulting Engineer.

## PRODUCTS.

Patentees and sole manufacturers of steel for the CUMMINGS SYSTEM OF REINFORCED CONCRETE. Our laboratories make standard tests of cement and steel at the Mills before shipment, and our facilities are unexcelled.

## ADVANTAGES.

Reinforced Concrete is strong, durable, economical and fireproof. It offers unsurpassed possibilities for rapid, substantial and permanent construction. Insurance and maintenance are reduced to the minimum.

## THE CUMMINGS SYSTEM.

The established success of the Cummings System is due to the most careful consideration of the details of construction and the economical distribution of steel for all stresses.

## THE SELF-SUPPORTING LOOPED BARS. (PATENTED)

These are formed by shaping the tension bars into long rectangular frames and bending up the ends of the frames to resist sheering stresses. The looped ends form an anchorage by which the steel is self-supporting, and cannot be disarranged nor omitted.

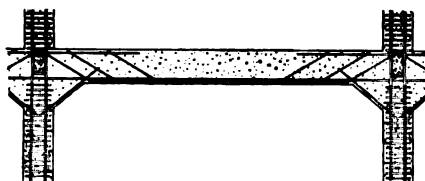

CUMMINGS SYSTEM OF  
REINFORCEMENT

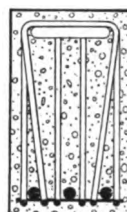

CUMMINGS  
LOOPED  
BARS

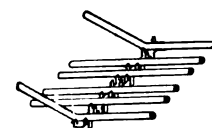

CUMMINGS  
SUPPORTING AND  
SPACING CHAIR

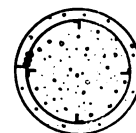

CUMMINGS  
SELF-CENTERING  
HOOPS AND  
SPACING  
VERTICALS FOR  
COLUMNS

## THE SUPPORTING AND SPACING CHAIRS. (PATENTED)

These sheet steel Chairs have projections bent up for spacing and others bent down to support the reinforcement in its exact position when placing the concrete. These Chairs should be used in all work, as they are entirely imbedded in the concrete and are not seen on removing the moulds.

## THE SELF-CENTERING HOOPS AND VERTICALS FOR COLUMNS. (PATENTED)

These Hoops have an end bent outwardly, thus fixing the reinforcement concentrically in the column. Self-centering Hoops increase the safe compressive value of concrete at least four-fold. The spacing verticals for hoops are also utilized for bending stresses in the column. The size of the Cummings Column is no greater than a structural steel column for similar loads.

## CONCRETE PILE FOUNDATIONS. (PATENTED)

Difficult foundations demand skilled treatment. Concrete piles frequently offer the most economical solution. Our method of driving concrete piles is the result of a long special study. It is the most simple and efficient yet devised. Our method of making "cast" piles "in situ" is of equal merit.

## ESTIMATES.

We will design or contract for all work where reinforced concrete can be used. We will make estimates and suggestions free of charge and solicit inquiries upon the Cummings System.

## GUARANTEE.

We guarantee our workmanship to be strictly as represented.