

1. SITE I.D. NO.

# HAER INVENTORY

27-3213  
TRONR 4E 518

Historic American Engineering Record  
Department of the Interior, Washington, D.C. 20240

2. INDUSTRIAL CLASSIFICATION

Bridges, Trestles, and Aqueducts

7 6 0 3

3. PRIORITY

4. DANGER OF DEMOLITION?

(SPECIFY THREAT)

Life expectancy:

YES  NO  UNKNOWN

TRUSS: Steel

5. DATE

1931/00

6. GOVT SOURCE OF THREAT

OWNER

ADMIN

State/County/Volgov Designation #:  
1820 4A 270965900091 00

7. OWNER/ADMIN

STATE/County/MUNICIPALITY

Original Owner:

8. NAME(S) OF STRUCTURE

Puyallup River Bridge  
(George Milroy Bridge) between 410 and Levee Road

9. OWNER'S ADDRESS

County Public Works Department  
City-County Building  
930 Tacoma Avenue Tacoma, WA 98402

10. STATE COUNTY

W A  
0 5 3

COUNTY NAME

Pierce

CITY/VICINITY

CONG. DIST.

0 3

STATE COUNTY

W A

COUNTY NAME

CITY/VICINITY

CONG. DIST.

11. SITE ADDRESS (STREET & NO) /Crossing:

410-5 miles east of Route 5  
S.T.R. 18 20 4E

31973

12. EXISTING SURVEYS

NR  NHL  HABS  HAER-I  HAER  NPS  CL6  
 CONF  STATE  COUNTY  LOCAL  OTHER

13. SPECIAL FEATURES (DESCRIBE BELOW)

INTERIOR INTACT  EXTERIOR INTACT  ENVIRONS INTACT

14. UTM ZONE

EASTING

NORTHING

SIGN

SCALE

1:24  1:62.5

QUAD NAME

UTM ZONE

EASTING

NORTHING

SIGN

SCALE

1:24  1:62.5

QUAD NAME

15. CONDITION

70  EXCELLENT

71  GOOD

72  FAIR

73  DETERIORATED

74  RUINS

75  UNEXPOSED

76  ALTERED

82  DESTROYED

85  DEMOLISHED

16. INVENTORIED BY

Lisa Soderberg

AFFILIATION

HAER/Washington State Bridge Inventory

DATE

3/79

17. DESCRIPTION AND BACKGROUND HISTORY, INCLUDING CONSTRUCTION DATE(S), HISTORICAL DATE(S), PHYSICAL DIMENSIONS, MATERIALS, EXTANT EQUIPMENT, AND IMPORTANT BUILDERS, ENGINEERS, ETC.

Designer:

Builder/Contractor: Hart Construction Company

This Pennsylvania Petit riveted through truss span, erected in 1931 by the Hart Construction Company, is 308 feet long and 20 feet wide. The overall length of the bridge which includes 2 concrete stringer approach spans is 345 feet long.

(CONT OVER)

18. ORIGINAL USE

Bridge /vehicular

PRESENT USE

Bridge/vehicular

ADAPTIVE USE

19. REFERENCES - HISTORICAL REFERENCES, PERSONAL CONTACTS, AND/OR OTHER

County Highway Commission files  
Nameplate

(CONT OVER)

20. URBAN AREA 50,000 POP. OR MORE?

YES  NO

21. NPS REGION

N W

22. PUBLIC ACCESSIBILITY

YES, LIMITED  YES, UNLIMITED  
 NO  UNKNOWN

23. EDITOR INDEXER

24. LOCATED IN AN HISTORIC DISTRICT?

YES  NO

NAME

DISTRICT I.D. NO

DESIGN INFORMATION

Architectural or Decorative Features:

Superstructure  
 Pennsylvania Petit Truss riveted

31973

STRUCTURAL INFORMATION

Length Overall: 345'  
 Length Maximum Span: 308'

Main Unit Span      Type: 310      Number: 1

Secondary Spans    Type: 308      Number: 2

Number	Type	Length

Width: 20'      c to c

Clearance:      low water:      high water:  
 Navigable:

Substructure

- Foundations:
- Piers/bents:
- Abutments:
- Wings:
- Seats:

Floor System

- End Beams:
- Longitudinal Beams:
- End Stringers:
- Surfacing: concrete
- timber sidewalk

Connections/Expansion Joints

- Pin:
- Rigid:

Load Limit:

Existing Blueprints or Plans: County File

Site Map:

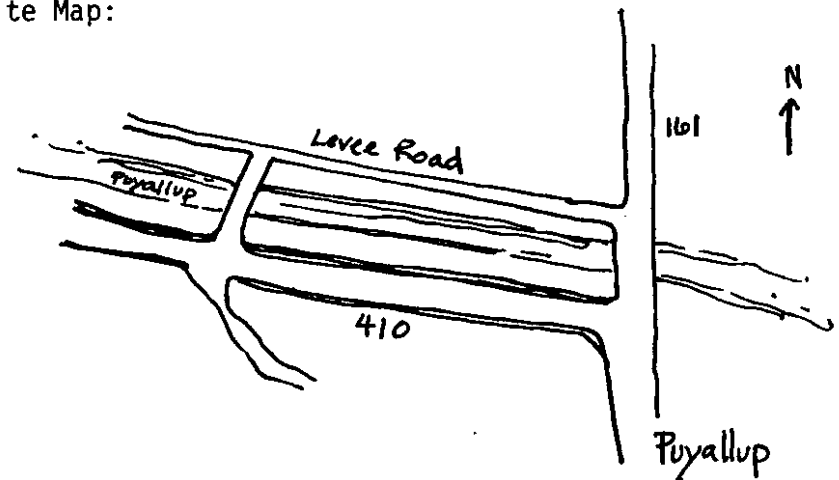

31793

Truss Configuration

Main Span Type:

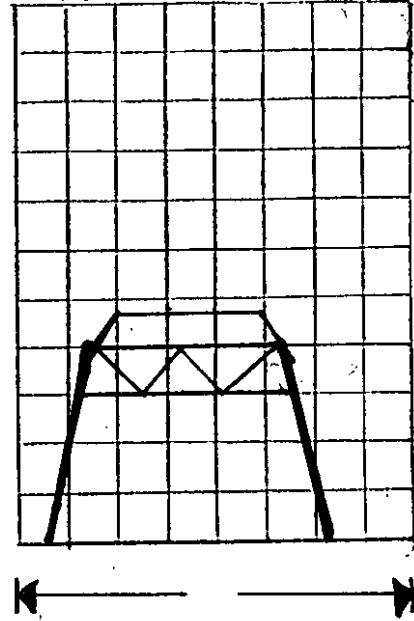
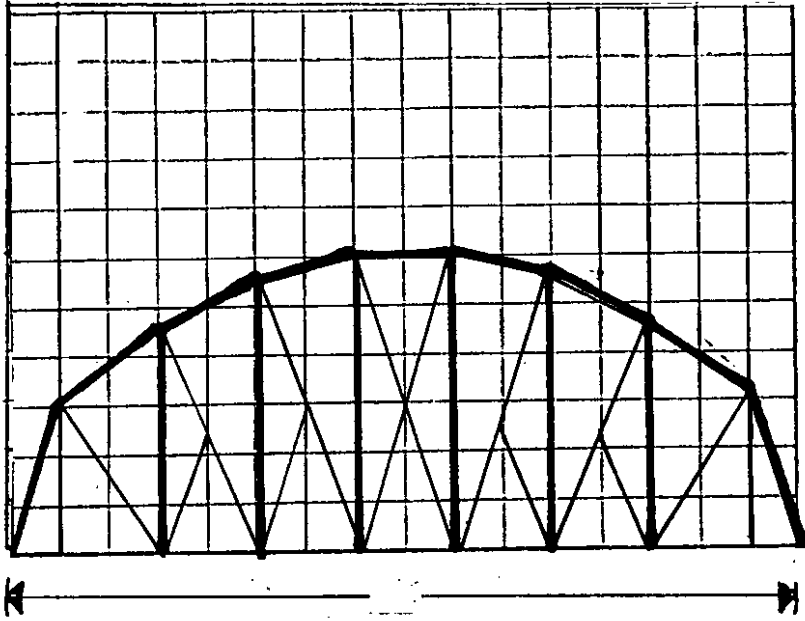

Secondary Span Type:

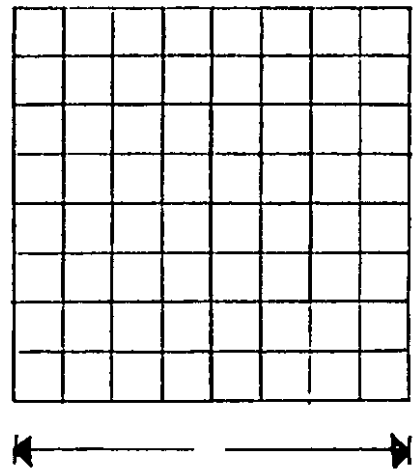
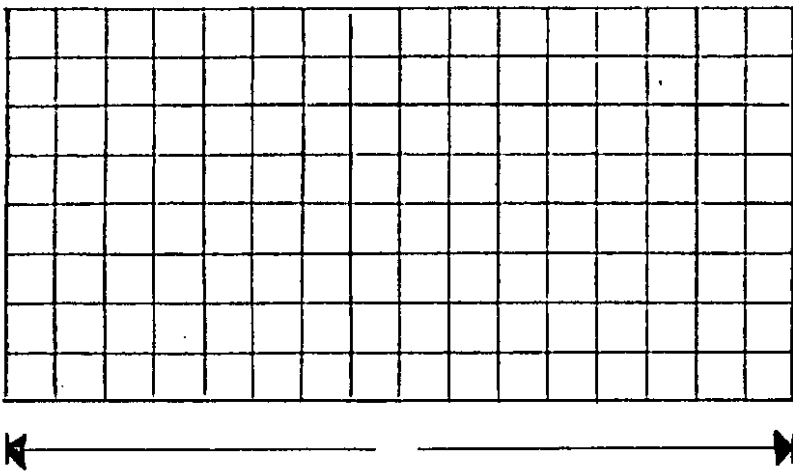

31973

TRUSS BRIDGES

Bridge Name: Puyallup River Bridge

Pierce County

Superstructure

Number of panels:

Top Chords: 2 channels with latticing and cover plate (double lacing)

Bottom Chords:

End Posts: 2 channels with latticing and cover plate (double lacing)

Hip Vertical: 2 angles with batten plates

Intermediate Posts: 2 double angles connected with lacing bars

Diagonals: 2 angles with batten plates

Counters: 2 double angles with lacing bars

Top Lateral Struts: 2 double angles connected with double lacing bars

Top Lateral Bracing: 2 double angles connected with double lacing bars.

Sway Struts: single angle:

Sway Bracing:  single angle

Portal Struts: 2 double angles connected with double lacing bars

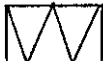
Portal Bracing:  2 double angles connected with lacing bars.

Railing: two angles with double lacing.

31793

PUYALLUP RIVER BRIDGE (George Milroy Bridge) 18204A 1931 Sec 18 T20N R4E



27

1

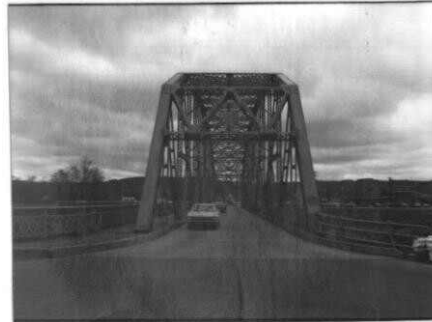

27

4



27

2



27

5



27

3



27

6



## Historic Property Inventory Report

---

### Location

---

Field Site No. DAHP No. 27-03213

Historic Name: George Milroy Bridge

Common Name: Puyallup River Bridge; Pierce County Bridge #18204A

Property Address: between 410 and Levee Rd , Puyallup, WA

Comments:

Tax No./Parcel No.

Plat/Block/Lot

Acreage

Supplemental Map(s)

---

Township/Range/EW	Section	1/4 Sec	1/4 1/4 Sec	County	Quadrangle
T20R04E	18			Pierce	

---

### Coordinate Reference

---

Easting: 1182773

Northing: 691196

Projection: Washington State Plane South

Datum: HARN (feet)



# Historic Property Inventory Report

---

## Identification

---

Survey Name: Legacy for City of Puyallup Date Recorded: 01/01/1900  
Field Recorder:  
Owner's Name:  
Owner Address:  
City: State: Zip:  
Classification:  
Resource Status: Comments:  
Within a District?  
Contributing?  
National Register:  
Local District:  
National Register District/Thematic Nomination Name:  
Eligibility Status: Not Determined - SHPO  
Determination Date: 1/1/0001  
Determination Comments:

## Description

---

Historic Use: Current Use:  
Plan: Stories: Structural System:  
Changes to Plan: Changes to Interior:  
Changes to Original Cladding: Changes to Windows:  
Changes to Other:  
Other (specify):  
Style: Cladding: Roof Type: Roof Material:  
Foundation: Form/Type:

## Narrative

---

Study Unit	Other
Date of Construction:	Builder: Engineer: Architect:

Property appears to meet criteria for the National Register of Historic Places:  
Property is located in a potential historic district (National and/or local):  
Property potentially contributes to a historic district (National and/or local):  
Statement of Significance:



## Historic Property Inventory Report

---

Description of  
Physical  
Appearance:  
Major  
Bibliographic  
References:





# Historic Property Inventory Report

---

## Photos

---